

HIWIN®

MULTI-AXIS ROBOT

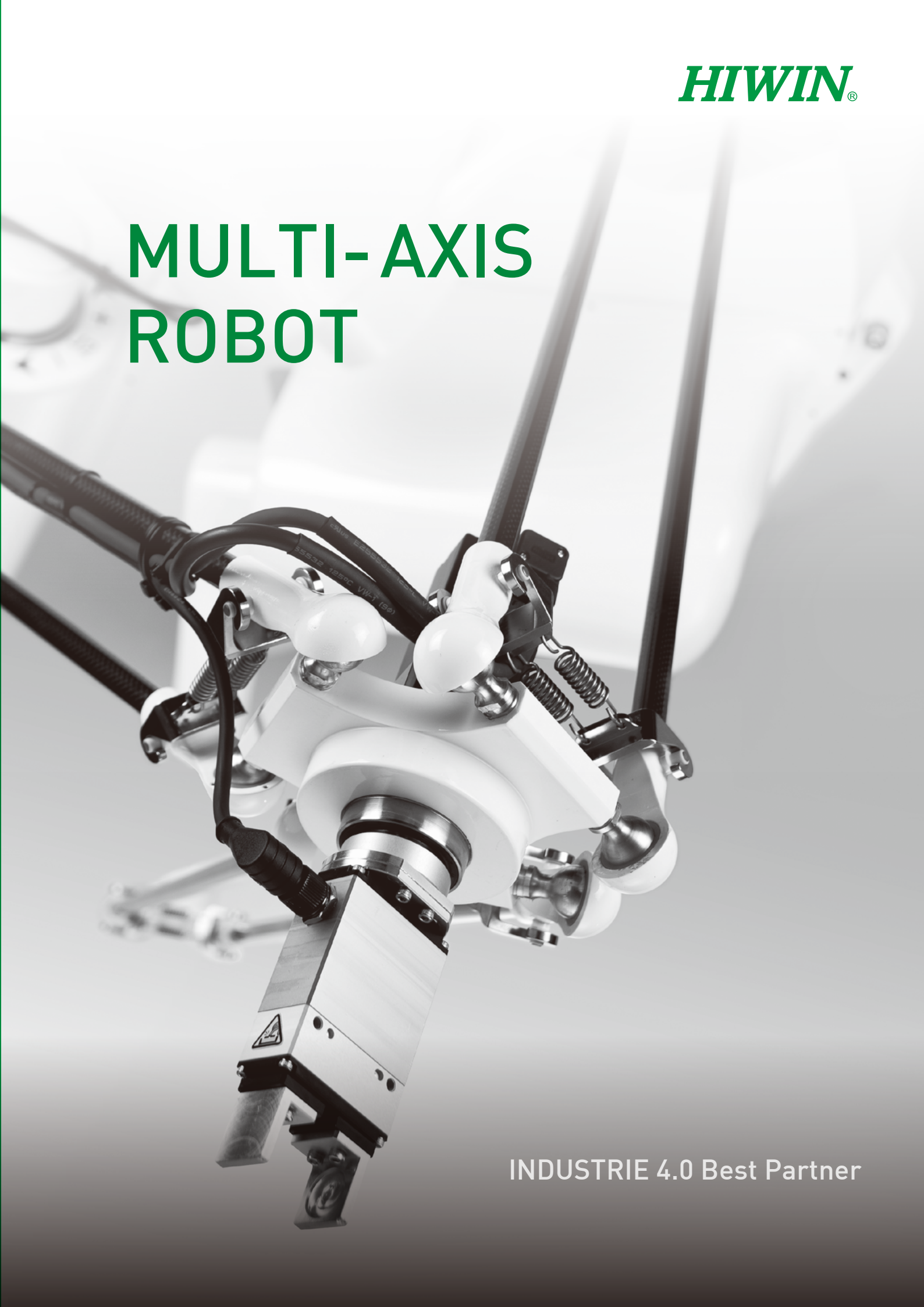

INDUSTRIE 4.0 Best Partner

Articulated Robot

RA 605

RT 605



RT605

RA605

Dimensions

Features

- Possessing high degree of freedom and flexibility, this light weight, articulated robot can automate highly complex manual tasks in unfriendly and unsafe work environments.

Application

- Loading/unloading, packaging, aligning, assembly, deburring, polishing, dispensing, stacking and inspection.

Model		RA605-GB	RT605-GB	
Degrees of freedom		6		
Rated payload [kg]		5		
Max. reach radius [mm]		710	710	909
Working range [°]	J1	± 165		
	J2	+85 ~ -125		
	J3	+185 ~ -55		
	J4	± 190		
	J5	± 115		
	J6	± 360		
Repeatability [mm]		± 0.02	± 0.03	± 0.04
Cycle time [s]*Note 1		0.5		
Weight [kg]		40	40	45
Protection rating		IP65	IP32	
Controller		RCA605-GB	RCT605-GB	
Tool pneumatic pipes *Note 2		Three channels of tracheal connection	Two channels of tracheal connection	

* Note 1: Based on a back-and-forth movement over a vertical distance of 25mm and a horizontal distance of 300mm.

Note 2: Apply with M5 thread Ø4 tracheal caliber connector.

Model / Dimensions	V _A	V _B	V _C	V _D	V _E	V _F	V _G	V _H	V _I	V _J	V _K	V _L	V _M	V _N	V _O	V _P	V _Q	V _R	V _S
RA605-710-GB RT605-710-GB	710	649	281	434	309	269	R340	160	1055	R680	211	R429.3	101.7°	67	138.3°	R242	338	R272	812
RT605-909-GB	909.8	848.1	363.3	451.7	408.3	368.5	R439.8	317.2	1254.8	R879.8	292.9	R564.3	100.2°	24.7	139.8°	R302.5	438	R332.5	911.75

Unit:mm

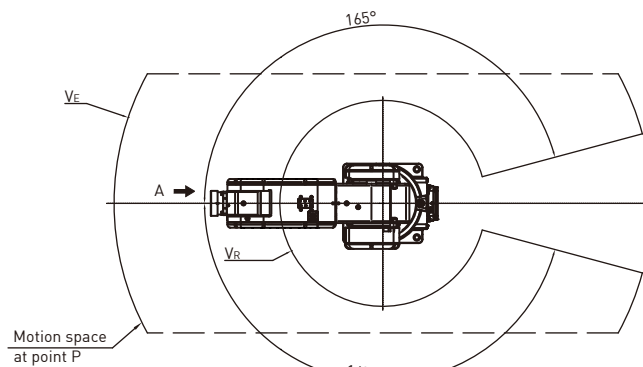

Top View

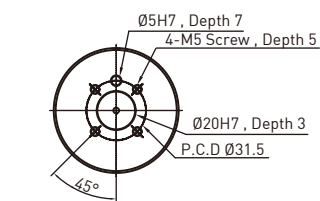

VIEW A
Mechanical Interface Detail

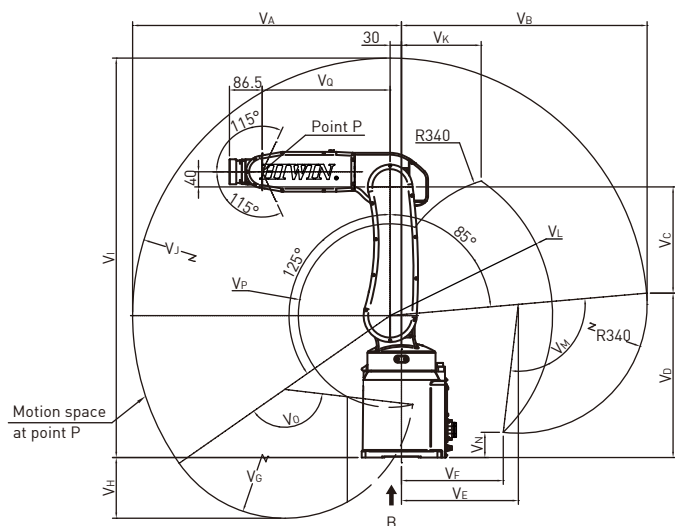

Side View

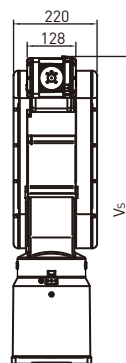

Front View

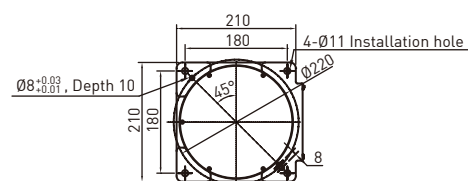

VIEW B
Installation Dimension Detail

Articulated Robot

RA 610

RT 610



Dimensions

Model / Dimensions	V _A	V _B	V _C	V _D	V _E	V _F	V _G	V _H	V _I	V _J	V _K	V _L	V _M
RA610-1355-GB RT610-1355-GB	1075	1355	1663	680	R575	182	552	R1215	R232.5	R688	159°	111.2°	R372.5
RA610-1476-GB RT610-1476-GB	1196	1476	1785	802	R697	304	678	R1336	R228	R904	161°	95°	R368
RA610-1672-GB RT610-1672-GB	1392	1672	1981	998	R892	500	878	R1532	R323	R951	164.7°	105.3°	R463
RA610-1869-GB RT610-1869-GB	1589	1869	2178	1196	R1089	697	1078	R1729	R490	R1129	166.6°	103.4°	R630

Unit:mm

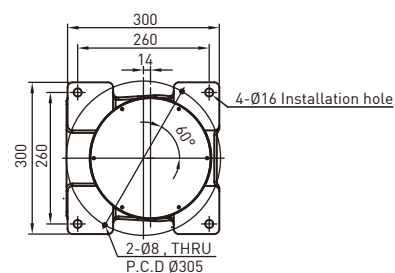
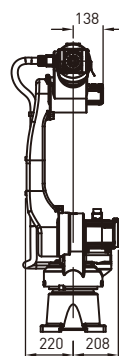
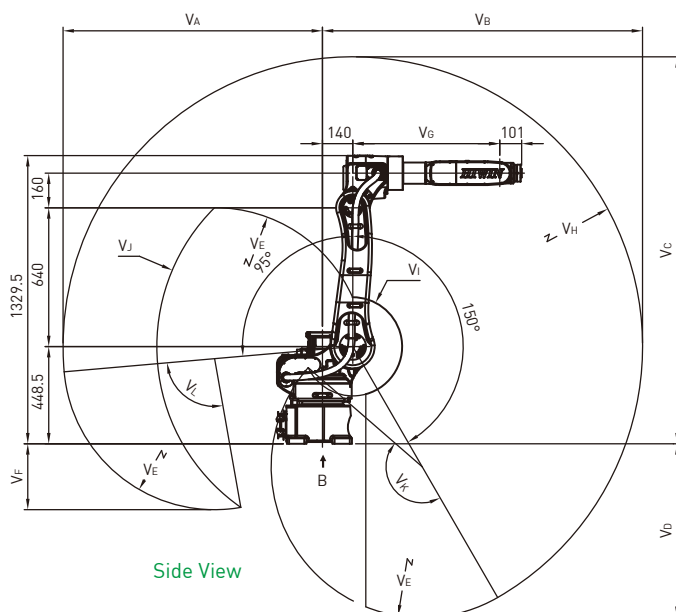
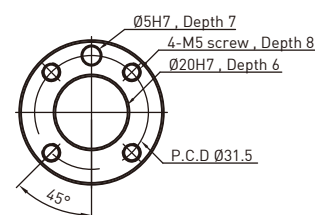
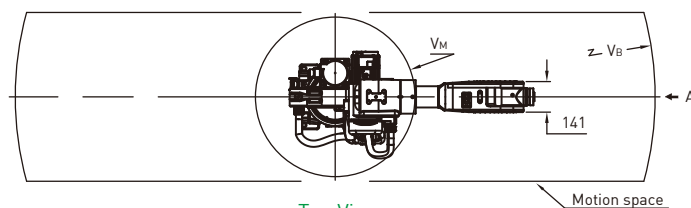

Features

- Possessing high degree of freedom and high load capacity with multiple reach radius and end effector options for integration into a variety of automation applications.

Application

- Loading/unloading, palletizing, assembly, polishing, dispensing, packaging, aligning and inspection.

Model		RA610-GB				RT610-GB			
Degrees of freedom		6							
Rated payload [kg]		12	10	10	7	12	10	10	7
Max. reach radius [mm]		1355	1476	1672	1869	1355	1476	1672	1869
Working range [°]	J1	± 170							
	J2	+95 ~ -150							
	J3	+185 ~ -85							
	J4	± 190							
	J5	± 135							
	J6	± 360							
Repeatability [mm]		± 0.05		± 0.06		± 0.05		± 0.06	
Cycle time [s]*Note 1		1							
Weight [kg]		143	147	150	152	143	147	150	152
Protection rating		IP54(Wrist:IP65)				IP32			
Controller		RCA610-GB				RCT610-GB			
Tool pneumatic pipes *Note 2		Two solenoid valves of tracheal connection				Two channels of tracheal connection			

* Note 1: Based on a back-and-forth movement over a vertical distance of 25mm and a horizontal distance of 300mm.

Note 2: The pipes are applied with M5 thread Ø4 tracheal caliber connector.

Articulated Robot

RA 620



RA620-1739

Features

- Possessing high degree of freedom and high load capacity with multiple reach radius and end effector options for integration into a variety of automation applications.

Application

- Loading/unloading, palletizing, assembly and polishing.

Degrees of freedom		6	
Rated payload [kg]		30	20
Max. reach radius [mm]		1621	1739
Working range [°]	J1	± 180	
	J2	+100 ~ - 135	
	J3	+190 ~ -80	
	J4	± 200	
	J5	± 130	
	J6	± 360	
Repeatability [mm]		± 0.06	
Cycle time [s]*Note 1		0.9	
Weight [kg]		226	230
Protection rating		IP54(Wrist:IP65)	
Controller		RCA620	

* Note 1: Based on a back-and-forth movement over a vertical distance of 25mm and a horizontal distance of 300mm.

Dimensions

Model / Dimensions	V _A	V _B	V _C	V _D	V _E	V _F	V _G	V _H	V _I	V _J	V _K	V _L	V _M
RA620-1621	1321	1621	1996	721	R701	310	685	R1471	R293	R821	158°	112°	R443
RA620-1739	1439	1739	2114	838	R819	428	805	R1589	R288	R906	159°	111°	R438

Unit:mm

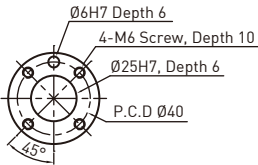
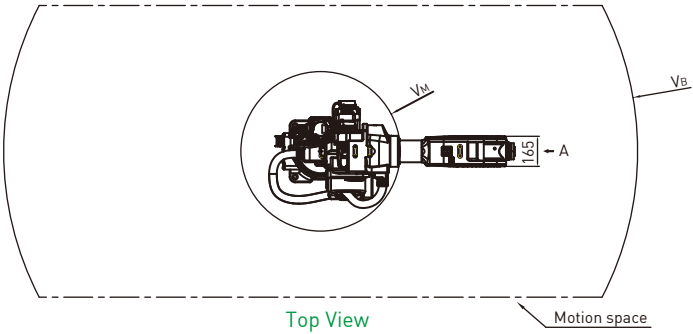

VIEW A
Mechanical Interface Detail

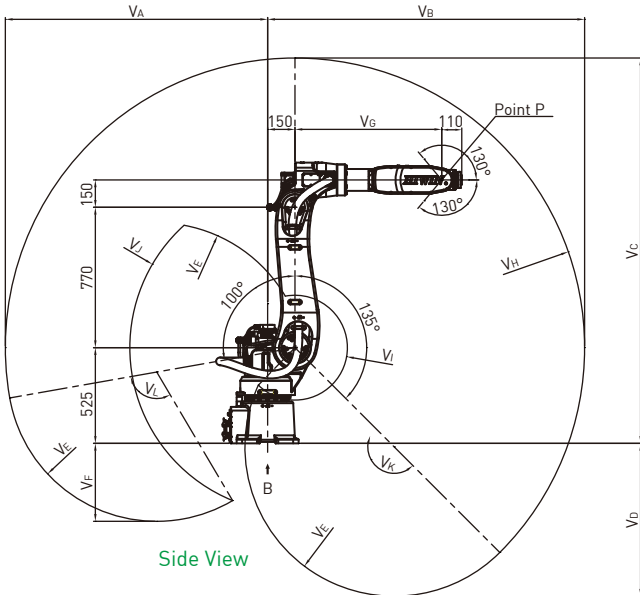

Side View

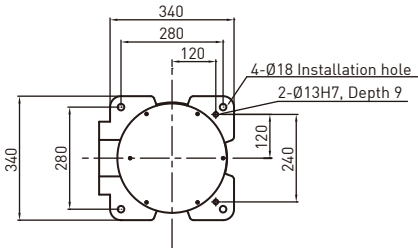
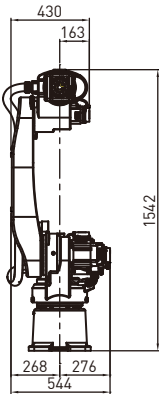

VIEW B
Installation Dimension Detail

Delta Robot

RD 403



RD403-1100-PR-GB

Dimensions

Model / Dimensions	V _A	V _B
RD403-1100-GB RD403-1100-FS	31.9	23.9
RD403-1100-PR-GB	39.5	31.5

Unit:mm

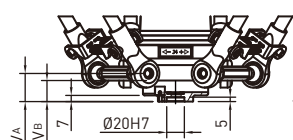
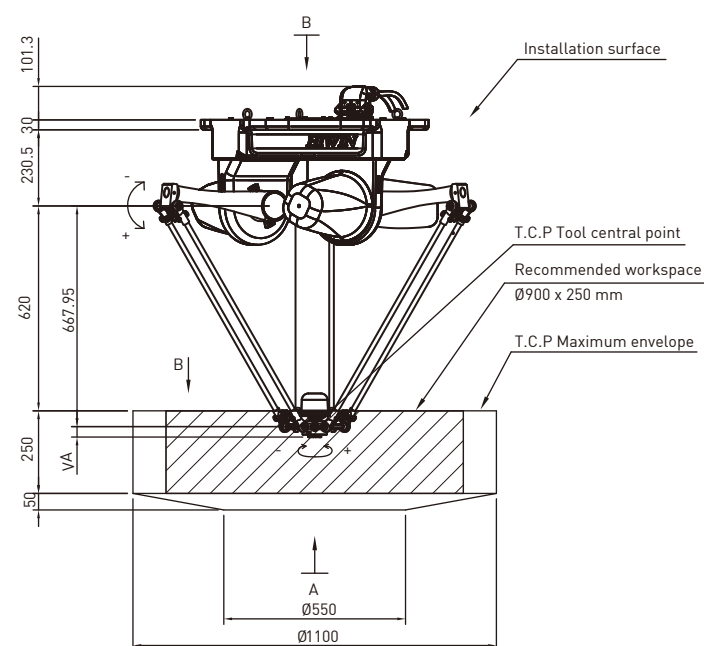

VIEW A

Features

- By utilizing a parallel linkage mechanism, the RD403 can execute high speed motion in a larger work area, with motion stability, short cycle times, high accuracy, high load capacity.
- Integrated with conveyor tracking and a vision positioning system, the RD403 achieves efficient, high-speed, in-line sorting, picking and placing.
- With IP65 certification, the RD403 can be used for automation applications in industries that have requirements for health and safety compliance.
- The RD403-1100-FS design complies with EN1672-2 requirements for food safety and can be used in food industry automation.

Application

- Packaging, arranging, assembly, picking, stacking and inspection.

Model	RD403-1100-GB	RD403-1100-FS	RD403-1100-PR-GB
Degrees of freedom		4	
Rated payload [kg]		3	
Max working diameter [mm]		1100	
Max working height [mm]		300	
Repeatability [mm]		± 0.1	
Cycle time [s]*Note 1		0.3	
Weight [kg]		95	
Protection rating		IP65	
Controller		RCD403-GB	
Food processing machinery	-	EN1672-2	-

* Note 1: Based on a back-and-forth movement over a vertical distance of 25mm and a horizontal distance of 300mm.

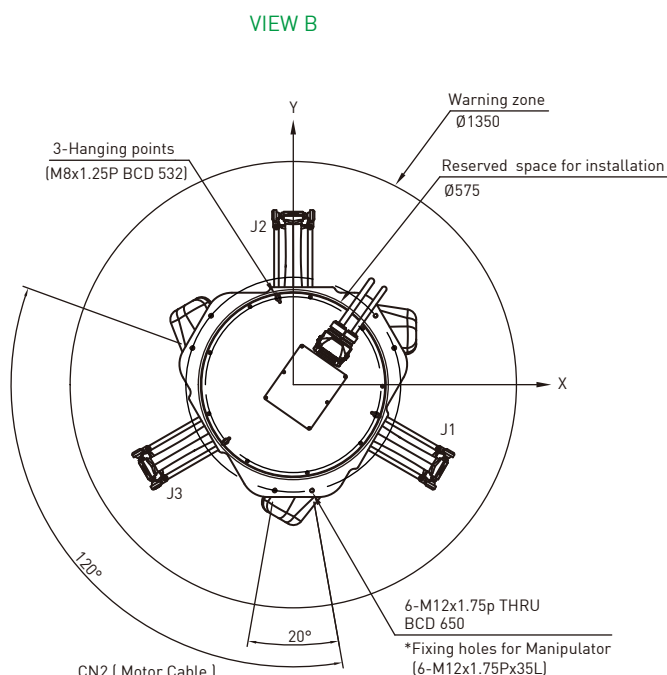

Battery retainer

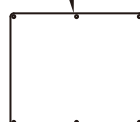

CN2 (Motor Cable)



*Fixing holes for Manipulator (6-M12x1.75Px35L)

SCARA Robot

RS Series



RS406

RS403

Dimensions

Model / Dimensions	V _A *	V _B *	V _C	V _D	V _E *	V _F	V _G	V _H	V _I	V _J	V _K	V _L	V _M	V _N	V _O	V _P	V _Q	V _R	V _S	V _T	V _U	V _V	V _W	V _X	V _Y	V _Z
RS403	330	494	649.1	677.3	-15.2	606	175	225	R457	R400	R225	R176.5	10	Ø11	Ø16	10	10	30	R17.5	2-M4X0.7P	12	24	45	30	11	172
RS406	410	572.8	878.4	720.8	37.2	835	275	325	R660	R600	R325	R162.6	11	Ø14	Ø20	-	-	30	R19	2-M3X0.5P	15	30	15	45	9	168

* : Dimension will be different when select optional J4 dimension Unit:mm

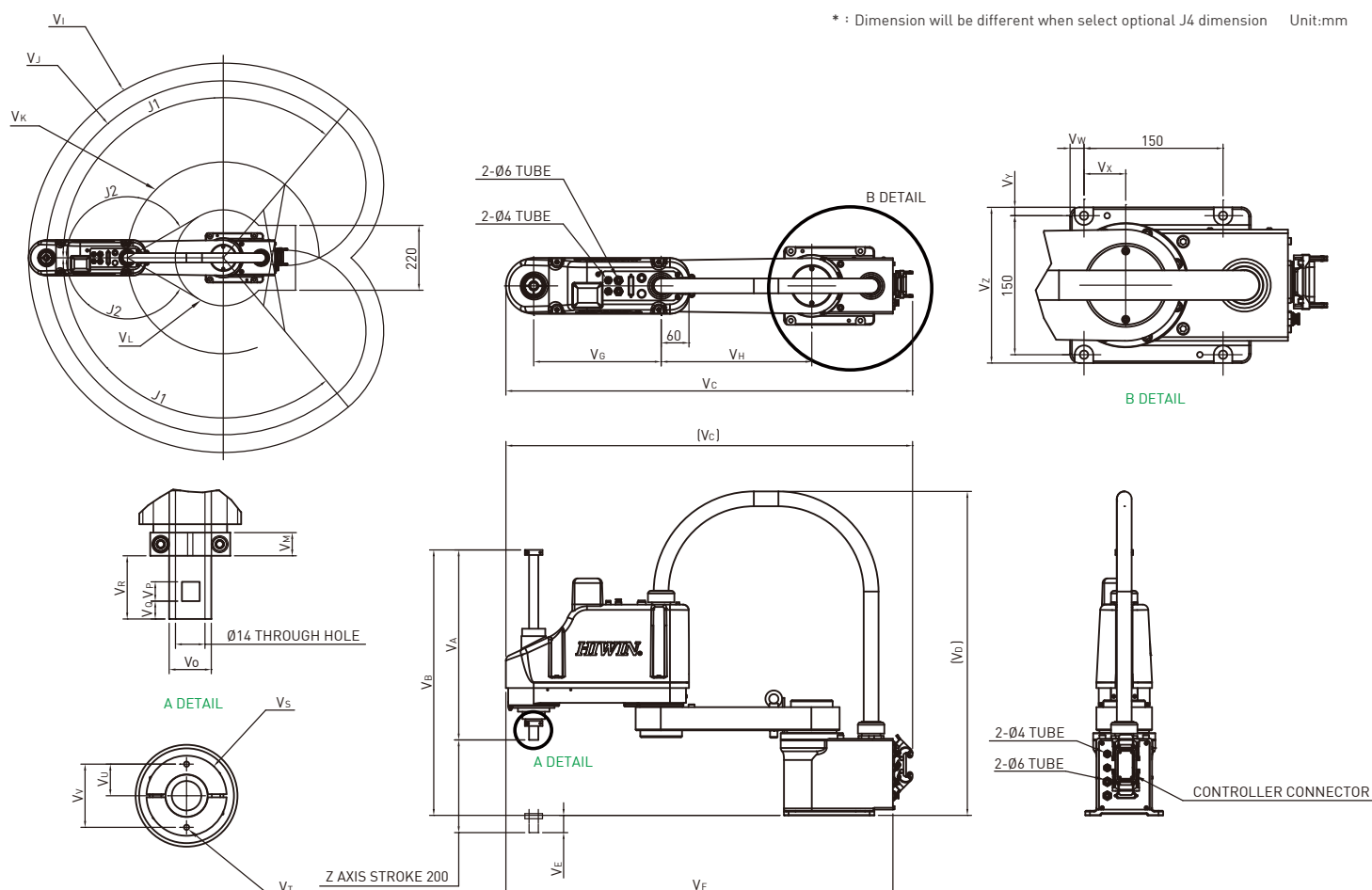

Features

- Possessing high precision and flexibility, a rotary axis can be added to the joint-end to increase the degree of freedom. Different end-effectors can be incorporated to achieve high precision assembly or rapid planar machining.

Application

- Loading/unloading, packaging, arranging, assembly, dispensing, stacking and inspection.

Model	RS403	RS406
Degrees of freedom	4	
Rated/Max. payload [kg]	1/3	2/6
Max. working radius [mm]	400	600
Working range	J1[°]	± 128
	J2[°]	± 130
	J3[°]	± 360
	J4[mm]	150
Repeatability	J1-J2[mm]	± 0.01
	J3[°]	± 0.01
	J4[mm]	± 0.01
Cycle time [s]*Note 2	0.42	0.45
Weight [kg]	16	22
Protection rating	IP20	
Controller	HRC-S410	

* Note 1: 300mm and 400mm length of J4-axis is optional.

Note 2: Based on a back-and-forth movement over a vertical distance of 25mm and a horizontal distance of 300mm.

Controller Series



RCA620



RCA605-GB

Dimension

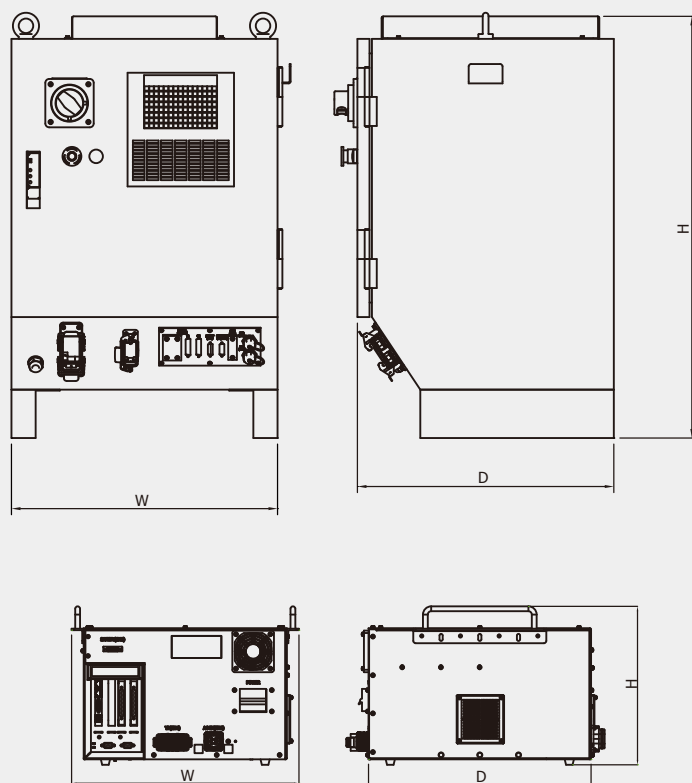

Specifications

Model		RCA605-GB, RCT605-GB	RCA610-GB, RCT610-GB	RCA620	RCD403-GB	HRC-S410
Control number of Axes		6	6	6	4	4
Weight [kg]		34	43	80	34	35
Power	Input voltage / frequency	1Ø200~240V 50/60Hz	1Ø200~240V 50/60Hz	3Ø200~240V *Note 1 50/60Hz	3Ø200~240V *Note 2 50/60Hz	1Ø220~240V 50/60Hz
	Max. current[A]	8A	18A	22A	4.5A	10A
◆ Input/Output *Note 3	Function I/O	8in/8out	8in/8out	8in/8out	8in/8out	11in/11out
	Digital I/O	24in/24out	24in/24out	16in/16out	24in/24out	-
◆ Communication Interface	RS232	✓	✓	-	✓	-
	Ethernet	✓	✓	✓	✓	✓
	Modbus	-	-	-	-	✓
	USB	✓	✓	✓	✓	✓
★ Encoder Capture		★	★	★	◆ 4ch	★
Ambient temperature [°C]		0~45	0~45	0~40	0~45	0~40
Ambient humidity [%]		20~75 (Non-condensing)	20~75 (Non-condensing)	45~85 (Non-condensing)	20~75 (Non-condensing)	20~80 (Non-condensing)
Protection rating		IP20	IP20	IP54	IP20	IP20
Dimensions [D x W x H]*Note 4		460 x 420 x 271	554 x 420 x 271	530 x 550 x 872	460 x 420 x 271	459 x 460 x 284

◆ Standard

★ Optional

Unit:mm

* Note 1: If the regional power source is 3Ø 380V, an additional transformer(3Ø 380V to 220V, 5KVA) should be applied.

Note 2: If the regional power source is 3Ø 380V, an additional transformer(3Ø 380V to 220V, 2KVA) should be applied.

Note 3: I/O can be expanded, but RCD403-GB is not included.

Note 4: Dimensions needed for cable installation is not included in the drawing.

Subsidiaries / Research Center

HIWIN GmbH
OFFENBURG, GERMANY
www.hiwin.de
www.hiwin.eu
info@hiwin.de

HIWIN JAPAN
KOBE · TOKYO · NAGOYA · NAGANO ·
TOHOKU · SHIZUOKA · HOKURIKU ·
HIROSHIMA · FUKUOKA · KUMAMOTO,
JAPAN
www.hiwin.co.jp
info@hiwin.co.jp

HIWIN USA
CHICAGO, U.S.A.
www.hiwin.com
info@hiwin.com

HIWIN Srl
BRUGHERIO, ITALY
www.hiwin.it
info@hiwin.it

HIWIN Schweiz GmbH
JONA, SWITZERLAND
www.hiwin.ch
info@hiwin.ch

HIWIN s.r.o.
BRNO, CZECH REPUBLIC
www.hiwin.cz
info@hiwin.cz

HIWIN SINGAPORE
SINGAPORE
www.hiwin.sg
info@hiwin.sg

HIWIN KOREA
SUWON · MASAN, KOREA
www.hiwin.kr
info@hiwin.kr

HIWIN CHINA
SUZHOU, CHINA
www.hiwin.cn
info@hiwin.cn

**Mega-Fabs Motion
Systems, Ltd.**
HAIFA, ISRAEL
www.mega-fabs.com
info@mega-fabs.com

HIWIN®

HIWIN TECHNOLOGIES CORP.

No. 7, Jingke Road,
Taichung Precision Machinery Park,
Taichung 40852, Taiwan
Tel: +886-4-23594510
Fax: +886-4-23594420
www.hiwin.tw
business@hiwin.tw

- HIWIN is a registered trademark of HIWIN Technologies Corp. For your protection, avoid buying counterfeit products from unknown sources.
- Actual products may differ from specifications and photos provided in this catalog. These differences may be the result of various factors including product improvements.
- HIWIN will not sell or export products or processes restricted under the "Foreign Trade Act" or related regulations. Export of restricted products should be approved by proper authorities in accordance with relevant laws and shall not be used to manufacture or develop nuclear, biochemical, missiles or other weapons.
- HIWIN website for patented product directory: http://www.hiwin.tw/Products/Products_patents.aspx

The specifications in this catalog are subject to change without notification.

Copyright © HIWIN Technologies Corp.

©2019 FORM C99DE08-1907 (PRINTED IN TAIWAN)